

O-RING KIT FOR MANITOU SWINGER 4&6 WAY COIL SHOCKS 2006-2009

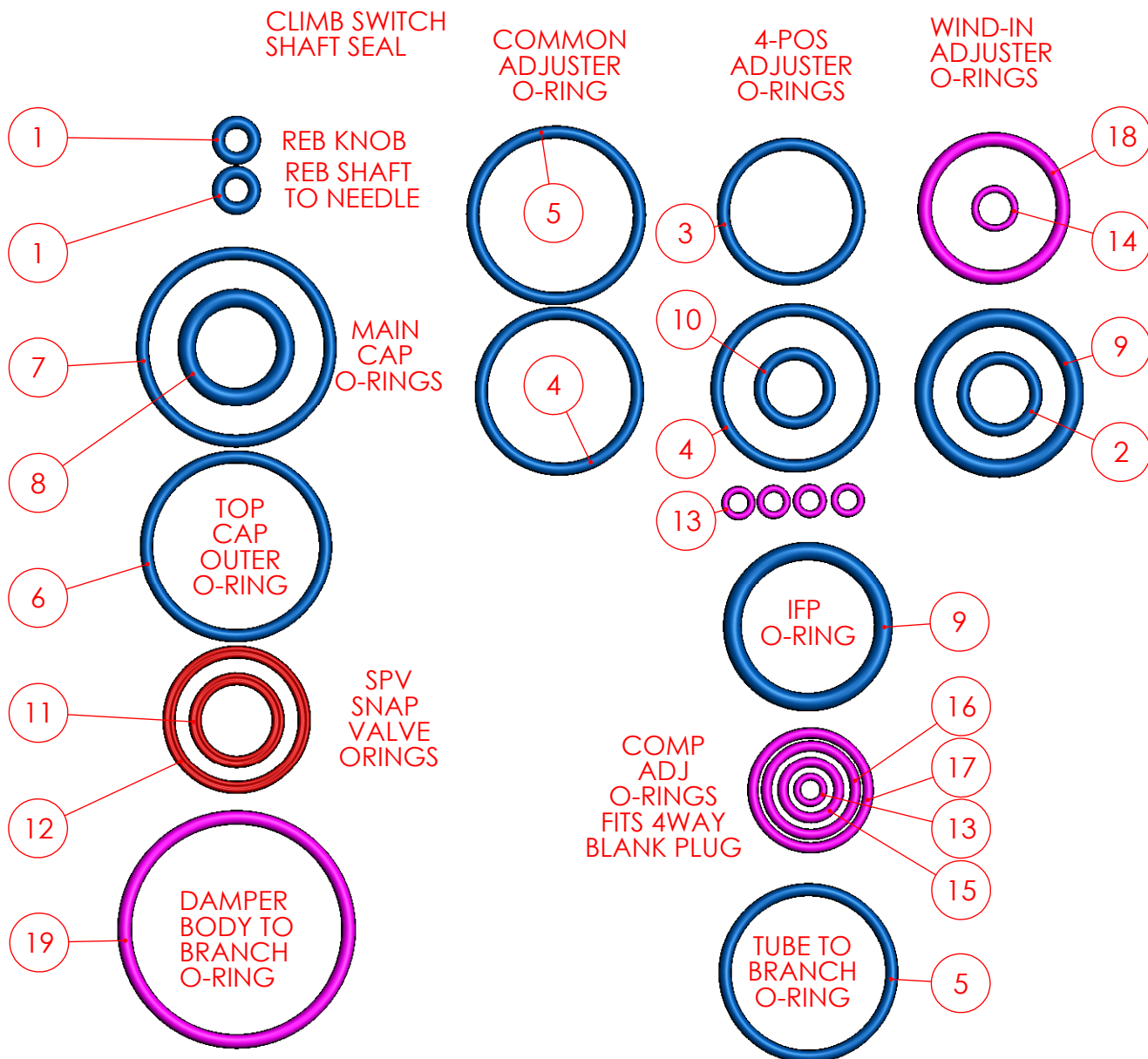

SERVICE INFO FOR MANITOU SWINGER 4/6 WAY COIL SHOCKS 2006-2009

Oil Specification: Motorex 2.5wt (15 cSt)
IFP Depth: See Table
IFP Fill: Schrader Valve
IFP Pressure: 50-175psi - This pressure sets compression damping

IDENTIFICATION:

SWINGER 4 WAY 2006-2009 IS A PIGGY BACK SHOCK WITH SPV DAMPER
- ADJUSTABLE REBOUND, PRELOAD, IFP VOLUME AND SPV PRESSURE (4 WAY ADJUSTABLE)
A ROUND BLANKING PLUG IS ON THE PIGGYBACK WITH A 5 POINT TOOL SOCKET
SWINGER 6 WAY 2006-2009 IS A PIGGY BACK SHOCK WITH SPV DAMPER
& COMP ADJUSTERS. ADJUSTABLE REBOUND, PRELOAD, LOW SPEED COMPRESSION,
HIGH SPEED COMPRESSION, IFP VOLUME AND SPV PRESSURE (6 WAY ADJUSTABLE)
CONCENTRIC REBOUND ADJUSTERS ARE ON THE PIGGYBACK

REVOX MODELS HAVE A 14MM SHAFT

2004-2005 4 WAY HAS NO COMP ADJUST, 6 WAY HAS INDIVIDUAL COMP ADJUSTERS
2006-2009 4 WAY HAS ROUND BLANK CAP, 6 WAY HAS CONCENTRIC COMP ADJUSTERS

IFP DEPTH ON INLINE SHOCKS
(SWINGER 3 WAY AND METEL R)
SET BY BOTTOMING SHAFT TO THREADS
WITH NO BUMPER ON THE SHAFT

BEST MANUAL BLEED IS BY THE
SHAFT HOLE WHEN HEAD AND
REBOUND NEEDLE REMOVED

IFP Depth TO PISTON OUTER LIP	SWINGER 4-6 WAY AIR	2006-2009 TOOLED VOLUME
Stroke Metric	Stroke Imperial	IFP Depth (mm)
38	1.5 inch	35
51	2 inch	38.5
57	2.25 inch	40
63	2.5 inch	41.5
70	2.75 inch	43
76	3 inch	44.5

TOOLS & SPARES:
EYELET BUSHINGS - Shockcraft 12mm DU bushing
SHAFT WIPER SEAL - Shockcraft 0.5 IN D Type Wiper Seal - NBR or PU
SHAFT BUSHING - Shockcraft 12.7 x 14.7 x 12.7 DU Bushing (Norglide)